

Township 18 South, Range 59 East Northeast Quarter

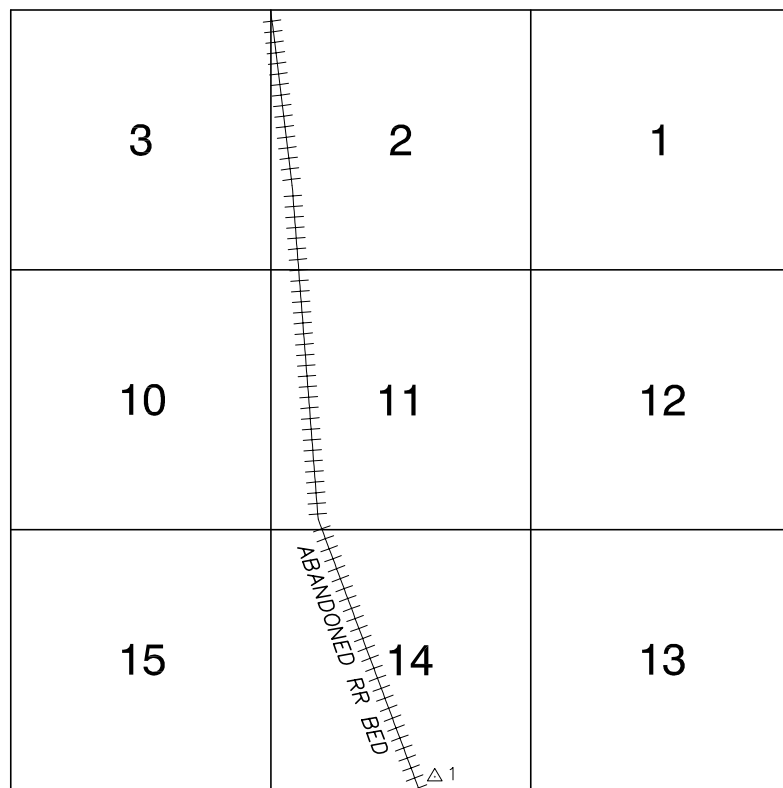

NORTH AMERICAN VERTICAL
DATUM OF 1988
— ALL ELEVATIONS IN METERS —

No.	STATION	ELEVATION (METERS)	DESCRIPTION
1	BM 111 1907	847.659	F N D 4" USGS BRASS CAP ON AN IRON PIPE 2' ABOVE THE GROUND, 90' SOUTHWEST OF A WOODEN POWER POLE WITH NO NUMBER, 5.0 MILES NORTHWEST OF THE INTERSECTION OF LOG CABIN WAY AND EL CAPITAN WAY ALONG AN ABANDONED RAILROAD BED.
2			
3			
4			
5			
6			
7			
8			
9			
10			
11			

CLARK COUNTY VERTICAL CONTROL v.2003

CLARK COUNTY SURVEYOR'S OFFICE
5051 SOUTH PARADISE ROAD
LAS VEGAS, NEVADA 89119
(702) 455-0640

CONVERSION FACTOR:
METERS X $\left(\frac{3937}{1200}\right)$ = U.S. SURVEY FEET

REVISED 2003

SHEET
1 OF 1

18-59
NE