

# Township 20 South, Range 60 East Northwest Quarter

LONE MOUNTAIN RD.

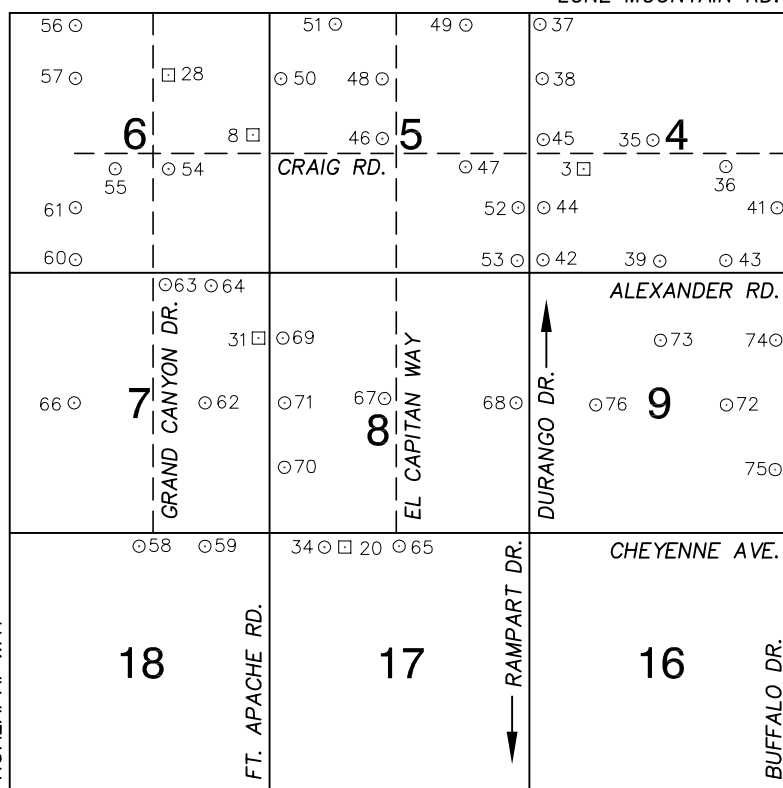

SMOKE RANCH RD.

NORTH AMERICAN VERTICAL  
DATUM OF 1988  
- ALL ELEVATIONS IN METERS -

No.	STATION	ELEVATION (METERS)	DESCRIPTION
1			LOST 2003
2			LOST 2003
3	1C00 4W6	726.792	FND RIVET AND SQUARE ALUMINUM PLATE IN AN ELECTRICAL TRANSFORMER PAD, 175' WEST OF AL GARRISON ST. ON THE SOUTH SIDE OF CRAIG RD.
4			LOST 2003
5			LOST 2003
6			LOST 2003
7			LOST 2003
8	1C00 6E4	759.465	FND RIVET AND SQUARE ALUMINUM PLATE IN SOUTHWEST CORNER OF AN ELECTRICAL TRANSFORMER PAD, 210' WEST OF FORT APACHE RD. AT 9245 CRAIG RD. ON THE NORTH SIDE OF CRAIG RD.
9			LOST 2003
10			LOST 2003
11			LOST 2003

CLARK COUNTY VERTICAL CONTROL v.2003

CLARK COUNTY SURVEYOR'S OFFICE  
5051 SOUTH PARADISE ROAD  
LAS VEGAS, NEVADA 89119  
(702) 455-0640

CONVERSION FACTOR:  
METERS X  $\left(\frac{3937}{1200}\right)$  = U.S. SURVEY FEET

REVISED  
09/01/2006

SHEET  
1 OF 4

20-60  
NW

No.	STATION	ELEVATION (METERS)	DESCRIPTION	No.	STATION	ELEVATION (METERS)	DESCRIPTION
12			LOST 2003	25			LOST 2003
13			LOST 2003	26			LOST 2003
14			LOST 2003	27			LOST 2003
15			LOST 2003	28	1C00 6N6	787.765	F N D RIVET AND SQUARE ALUMINUM PLATE IN A CONCRETE MONUMENT, 25' SOUTH AND 50' EAST OF GRAND CANYON DR. AND RED COACH AVE. 1' WEST OF AN ELECTRICAL VAULT.
16			LOST 2003	29			LOST 2003
17			LOST 2003	30			LOST 2003
18			LOST 2003	31	1C00 7NEE6	773.216	F N D RIVET AND SQUARE ALUMINUM PLATE IN A CONCRETE MONUMENT, 35' SOUTH AND 50' WEST OF FORT APACHE RD. AND GILMORE AVE.
19			LOST 1992	32			LOST 2003
20	1C00 17NNW6	768.036	F N D RIVET AND SQUARE ALUMINUM PLATE IN TOP OF CURB, ON THE SOUTH SIDE OF CHEYENNE AVE. AND THE EXTENDED ALIGNMENT OF CAMPBELL RD.	33			LOST 2003
21			LOST 2003	34	8LV00 17NNW6	768.417	F N D CITY OF LAS VEGAS RIVET AND ALUMINUM PLATE IN TOP OF CURB, SOUTHWEST CORNER OF CHEYENNE AVE. AND CAMPBELL RD.
22			LOST 1992	35	8LV00 4C4	722.067	F N D CITY OF LAS VEGAS RIVET AND ALUMINUM PLATE IN TOP OF CURB, NORTHWEST CORNER OF CRAIG RD. AND CIMARRON RD. NEAR 1/2 DELTA.
23			LOST 2003	<b>CLARK COUNTY VERTICAL CONTROL v.2003</b>  CLARK COUNTY SURVEYOR'S OFFICE 5051 SOUTH PARADISE ROAD LAS VEGAS, NEVADA 89119 (702) 455-0640			
24			LOST 2003				
				CONVERSION FACTOR: METERS X $\left(\frac{3937}{1200}\right)$ = U.S. SURVEY FEET  REVISED 2003			
				SHEET 2 OF 4 <b>20-60 NW</b>			

No.	STATION	ELEVATION (METERS)	DESCRIPTION		No.	STATION	ELEVATION (METERS)	DESCRIPTION			
36	8LV00 4E6	718.083	F N D	CITY OF LAS VEGAS RIVET AND ALUMINUM PLATE IN CONCRETE CYLINDER, SOUTHEAST CORNER OF CRAIG RD. AND CONOUGH LN. ±75' EAST OF CONOUGH LN.	49	8LV00 5NNE6	740.461	F N D	CITY OF LAS VEGAS RIVET AND ALUMINUM PLATE IN TOP OF CURB, SOUTHWEST CORNER OF LONE MOUNTAIN RD. AND RILEY ST. NEAR THE PT OF RILEY ST.		
37	8LV00 4NWS	734.125	F N D	CITY OF LAS VEGAS RIVET AND ALUMINUM PLATE IN TOP OF CURB, SOUTHEAST CORNER OF LONE MOUNTAIN RD. AND DURANGO DR. NEAR THE PT OF LONE MOUNTAIN RD.	50	6LV00 5NWW6	759.031	F N D	BLM BRASS CAP IN WELL, FORT APACHE RD. AND RED COACH AVE. ALIGNMENT.		
38	0LV00 4NWW6	731.271	F N D	CITY OF LAS VEGAS RIVET AND ALUMINUM PLATE IN TOP OF CURB, NORTHEAST CORNER OF DURANGO DR. AND RED COACH AVE. NEAR THE PT OF DURANGO DR.	51	8LV00 5NNW6	754.749	F N D	CITY OF LAS VEGAS RIVET AND ALUMINUM PLATE IN CONCRETE PAD, SOUTHEAST CORNER OF LONE MOUNTAIN RD. AND CAMPBELL RD. ±100' EAST OF CAMPBELL RD.		
39	6LV00 4S4	722.298	F N D	CITY OF LAS VEGAS RIVET AND ALUMINUM PLATE IN TOP OF CURB, NORTHEAST CORNER OF ALEXANDER RD. AND CIMARRON RD. NEAR THE PC OF ALEXANDER RD.	52	0LV00 5SEE6	730.541	F N D	CITY OF LAS VEGAS RIVET AND ALUMINUM PLATE IN TOP OF CURB, WEST SIDE OF ISLAND AT DURANGO DR. ±320' NORTH OF FLORINE AVE.		
40				LOST 2006	53	0LV00 5SES	732.411	F N D	CITY OF LAS VEGAS RIVET AND ALUMINUM PLATE IN TOP OF CURB, NORTHWEST CORNER OF ALEXANDER RD. AND DURANGO DR. NEAR 1/2 DELTA.		
41	1LV00 4SEE6	714.789	F N D	CITY OF LAS VEGAS RIVET AND ALUMINUM PLATE IN TOP OF CURB, SOUTHWEST CORNER OF BUFFALO DR. AND HICKAM AVE. NEAR 1/2 DELTA.	54	8LV00 6C4	779.976	F N D	CITY OF LAS VEGAS RIVET AND ALUMINUM PLATE IN CONCRETE PAD, SOUTHEAST CORNER OF CRAIG RD. AND GRAND CANYON DR. ±50' SOUTH OF CRAIG RD.		
42	1LV00 4SES	713.808	F N D	CITY OF LAS VEGAS RIVET AND ALUMINUM PLATE IN TOP OF CURB, NORTHWEST CORNER OF BUFFALO DR. AND ALEXANDER RD. NEAR 1/2 DELTA.	55	8LV00 6C4W	787.369	F N D	CITY OF LAS VEGAS RIVET AND ALUMINUM PLATE IN TOP OF CURB, SOUTHEAST CORNER OF CRAIG RD. AND JENSEN ST. NEAR THE PC OF JENSEN ST.		
43	6LV00 4SSE6	718.315	F N D	CITY OF LAS VEGAS RIVET AND ALUMINUM PLATE IN TOP OF CURB, NORTHWEST CORNER OF ALEXANDER RD. AND POPPY FIELDS DR. NEAR THE PT OF ALEXANDER RD.	56	8LV00 6NNW6	808.394	F N D	CITY OF LAS VEGAS RIVET AND ALUMINUM PLATE IN CONCRETE CYLINDER, SOUTHWEST CORNER OF LONE MOUNTAIN RD. AND CONQUISTADOR ST.		
44	0LV00 4SWW6	730.026	F N D	BRASS CAP "PLS 7008" AT DURANGO DR. AND HICKAM AVE. ALIGNMENT.	57	8LV00 6NW6	804.439	F N D	CITY OF LAS VEGAS RIVET AND ALUMINUM PLATE IN CONCRETE PAD, SOUTHEAST CORNER OF CONQUISTADOR ST. AND RED COACH AVE.		
45	8LV00 4W4	729.980	F N D	CITY OF LAS VEGAS RIVET AND ALUMINUM PLATE IN TOP OF CURB, NORTHEAST CORNER OF CRAIG RD. AND DURANGO DR. NEAR THE PC OF CRAIG RD.	58	6LV00 18N4	805.793	F N D	CITY OF LAS VEGAS RIVET AND ALUMINUM PLATE IN TOP OF CURB, SOUTH SIDE OF CHEYENNE AVE. OPPOSITE GRAND CANYON DR.		
46	8LV00 5C4	742.448	F N D	CITY OF LAS VEGAS RIVET AND ALUMINUM PLATE IN CONCRETE PAD, NORTH SIDE OF CRAIG RD. ±30' WEST OF EL CAPITAN WAY.	59	8LV00 18NNE6	790.161	F N D	CITY OF LAS VEGAS RIVET AND ALUMINUM PLATE IN TOP OF CURB, SOUTH SIDE OF CHEYENNE AVE. ±100' EAST AND OPPOSITE OF MOUNTAIN VIEW LUTHERAN CHURCH.		
47	8LV00 5E6	735.924	F N D	CITY OF LAS VEGAS RIVET AND ALUMINUM PLATE IN CONCRETE CYLINDER, SOUTHEAST CORNER OF CRAIG RD. AND RILEY ST. NEAR 1/2 DELTA OF 6' WALL.	CLARK COUNTY VERTICAL CONTROL v.2003  CLARK COUNTY SURVEYOR'S OFFICE 5051 SOUTH PARADISE ROAD LAS VEGAS, NEVADA 89119 (702) 455-0640						
48	8LV00 5N6	743.134	F N D	CITY OF LAS VEGAS RIVET AND ALUMINUM PLATE IN CONCRETE CYLINDER, NORTHWEST CORNER OF EL CAPITAN WAY AND RED COACH AVE.							
					CONVERSION FACTOR: METERS X $\left(\frac{3937}{1200}\right)$ = U.S. SURVEY FEET		REVISED 09/01/2006		SHEET 3 OF 4	20-60 NW	

No.	STATION	ELEVATION (METERS)	DESCRIPTION	No.	STATION	ELEVATION (METERS)	DESCRIPTION
60	8LV00 6SSW6	806.307	F N D CITY OF LAS VEGAS RIVET AND ALUMINUM PLATE IN CONCRETE CYLINDER, NORTHWEST CORNER OF ALEXANDER RD. AND CONQUISTADOR ST.	73	8LV00 9N6	724.866	F N D CITY OF LAS VEGAS RIVET AND ALUMINUM PLATE IN TOP OF CURB, NORTHEAST CORNER OF CIMARRON RD. AND GILMORE AVE. NEAR THE PT OF CIMARRON RD.
61	8LV00 6SW6	797.711	F N D CITY OF LAS VEGAS RIVET AND ALUMINUM PLATE IN CONCRETE CYLINDER, NORTHWEST CORNER OF CONQUISTADOR ST. AND HICKAM AVE.	74	1LV00 9NEE6	714.052	F N D CITY OF LAS VEGAS RIVET AND ALUMINUM PLATE IN CONCRETE PAD, SOUTHWEST CORNER OF BUFFALO DR. AND CONSTANTINOPLE AVE. ±80' SOUTH OF CONSTANTINOPLE AVE.
62	9LV00 7E6	781.970	F N D CITY OF LAS VEGAS RIVET AND ALUMINUM PLATE IN TOP OF CURB, SOUTHWEST CORNER OF GOWAN RD. AND ST. AIDEN STREET, NEAR THE PC OF GOWAN RD.	75	8LV00 9SEE6	718.913	F N D CITY OF LAS VEGAS RIVET AND ALUMINUM PLATE IN TOP OF CURB, NORTHWEST CORNER OF BUFFALO DR. AND BUCKSKIN AVE. NEAR THE PT OF BUFFALO DR.
63	9LV00 7N4	792.858	F N D CITY OF LAS VEGAS RIVET AND ALUMINUM PLATE IN TOP OF CURB, SOUTHEAST CORNER OF ALEXANDER RD. AND GRAND CANYON DR. NEAR PC OF GRAND CANYON DR.	76	9LV00 9W6	733.491	F N D CITY OF LAS VEGAS RIVET AND ALUMINUM PLATE IN TOP OF CURB, NORTHWEST CORNER OF GOWAN RD. AND WARM BREEZE DR. NEAR THE PT OF GOWAN RD.
64	9LV00 7NNE6	780.959	F N D CITY OF LAS VEGAS RIVET AND ALUMINUM PLATE IN TOP OF CURB, SOUTH SIDE OF ALEXANDER RD. OPPOSITE TEE PEE LN.	77			
65	8LV00 17N4	759.992	F N D CITY OF LAS VEGAS RIVET AND ALUMINUM PLATE IN TOP OF CURB, SOUTH SIDE OF CHEYENNE AVE. OPPOSITE EL CAPITAN WAY.	78			
66	9LV00 7W6	802.072	F N D CITY OF LAS VEGAS RIVET AND ALUMINUM PLATE IN TOP OF CURB, NORTHEAST CORNER OF GOWAN RD. AND JENSEN ST. NEAR THE PC OF GOWAN RD.	79			
67	8LV00 8C4	752.978	F N D CITY OF LAS VEGAS RIVET AND ALUMINUM PLATE IN TOP OF CURB, NORTHWEST CORNER OF GOWAN RD. AND EL CAPITAN WAY, NEAR THE PC OF GOWAN RD.	80			
68	9LV00 8E4	739.102	F N D CITY OF LAS VEGAS RIVET AND ALUMINUM PLATE IN TOP OF CURB, NORTHWEST CORNER OF GOWAN RD. AND DURANGO RD. NEAR THE PC OF GOWAN RD.	81			
69	6LV00 8NWW6	771.837	F N D CITY OF LAS VEGAS RIVET AND ALUMINUM PLATE IN TOP OF CURB, SOUTHEAST CORNER OF FORT APACHE RD. AND GILMORE AVE. NEAR THE PC OF FORT APACHE RD.	82			
70	6LV00 8SWW6	774.754	F N D CITY OF LAS VEGAS RIVET AND ALUMINUM PLATE IN TOP OF CURB, NORTHEAST CORNER OF FORT APACHE RD. AND BUCKSKIN AVE. NEAR THE PC OF BUCKSKIN AVE.	83			
71	6LV00 8W4	772.422	F N D CITY OF LAS VEGAS RIVET AND ALUMINUM PLATE IN TOP OF CURB, SOUTHEAST CORNER OF GOWAN RD. AND FORT APACHE RD. NEAR THE PC OF GOWAN RD.	<b>CLARK COUNTY VERTICAL CONTROL v.2003</b>  CLARK COUNTY SURVEYOR'S OFFICE 5051 SOUTH PARADISE ROAD LAS VEGAS, NEVADA 89119 (702) 455-0640			
72	9LV00 9E6	721.084	F N D CITY OF LAS VEGAS RIVET AND ALUMINUM PLATE IN TOP OF CURB, NORTH SIDE OF GOWAN RD. OPPOSITE CONOUGH LN.				
				CONVERSION FACTOR: METERS X $\left(\frac{3937}{1200}\right)$ = U.S. SURVEY FEET  REVISED 2003      SHEET 4 OF 4 <b>20-60 NW</b>			