

Township 20 South, Range 61 East Northwest Quarter

LONE MOUNTAIN RD.

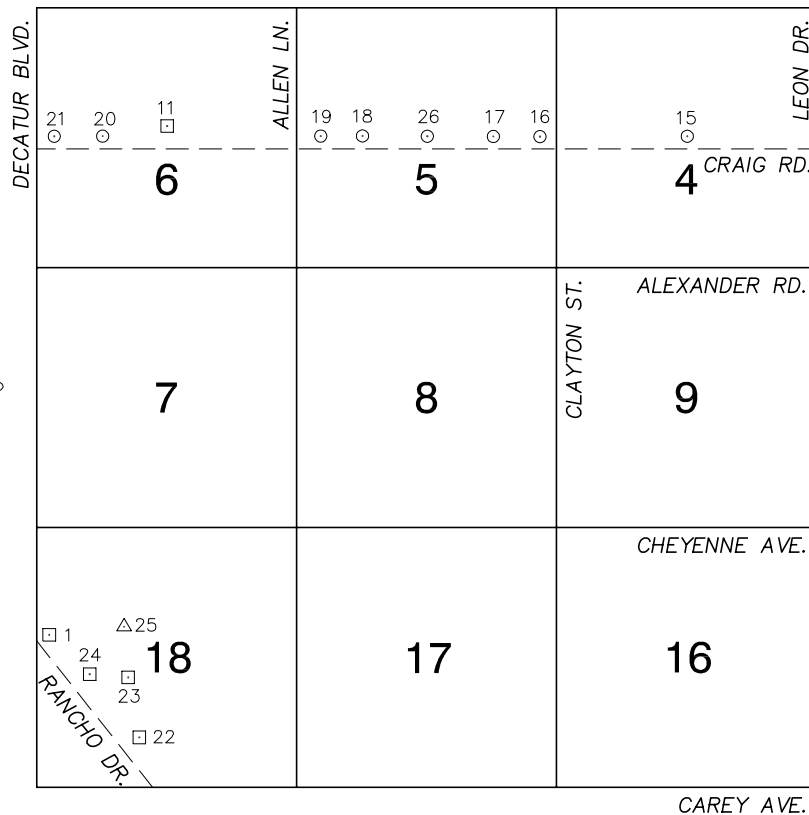

NORTH AMERICAN VERTICAL
DATUM OF 1988
— ALL ELEVATIONS IN METERS —

No.	STATION	ELEVATION (METERS)	DESCRIPTION
1	7C01 18W4	673.509	F N D RIVET AND SQUARE ALUMINUM PLATE IN TOP OF CURB, SOUTHEAST CORNER OF RANCHO DR. AND DECATUR BLVD. ON THE NORTH SIDE OF AIRPORT ENTRANCE ROAD NEAR THE PC OF RANCHO DR.
2			LOST 2003
3			LOST 2003
4			LOST 2003
5			LOST 2003
6			LOST 2003
7			LOST 2003
8			LOST 2003
9			LOST 2003
10			LOST 2003
11	7C01 6C4	670.260	F N D RIVET AND SQUARE ALUMINUM PLATE IN TOP OF CURB, EAST SIDE OF VALLEY DR. AND 200' NORTH OF THE CENTERLINE OF CRAIG RD.

CLARK COUNTY VERTICAL CONTROL v.2003

CLARK COUNTY SURVEYOR'S OFFICE
5051 SOUTH PARADISE ROAD
LAS VEGAS, NEVADA 89119
(702) 455-0640

CONVERSION FACTOR:
METERS X $\left(\frac{3937}{1200}\right)$ = U.S. SURVEY FEET

REVISED 2003

SHEET
1 OF 2

20-61
NW

No.	STATION	ELEVATION (METERS)	DESCRIPTION	No.	STATION	ELEVATION (METERS)	DESCRIPTION
12			LOST 2003	25	FAA VGT A	667.665	FND STAINLESS STEEL ROD IN SLEEVE, LOCATED AT THE NORTH LAS VEGAS AIRPORT, 500' NORTHEAST OF THE ADMINISTRATION BUILDING IN A MEDIAN BORDERED BY TAXI WAYS "BRAVO" AND "CHARLIE".
13			LOST 2003	26	NLV01 5C4	656.922	FND NORTH LAS VEGAS PIN AND PLATE IN TOP OF CURB, NORTHEAST CORNER OF CRAIG RD AND SIMMONS ST. NEAR THE PC OF CRAIG RD.
14			LOST 2003	27			
15	NLV01 4C4	637.333	FND NORTH LAS VEGAS PIN AND PLATE IN TOP OF CURB, NORTHEAST CORNER OF CRAIG RD. AND CAMINO AL NORTE / MARTIN L. KING BLVD. NEAR THE PC OF CRAIG RD.	28			
16	NLV01 5E4	646.590	FND NORTH LAS VEGAS PIN AND PLATE IN TOP OF CURB, NORTHWEST CORNER OF CRAIG RD. AND CLAYTON ST. 19' WEST OF THE PC OF CRAIG RD.	29			
17	7C01 5E6 1997	652.761	SET RIVET AND ROUND ALUMINUM PLATE IN TOP OF CURB, NORTHEAST CORNER OF CRAIG RD. AND COLEMAN ST. NEAR THE PC OF CRAIG RD.	30			
18	7C01 5W6 1997	661.753	SET RIVET AND ROUND ALUMINUM PLATE IN TOP OF CURB, NORTHEAST CORNER OF CRAIG RD. AND FERRELL ST. NEAR THE PC OF CRAIG RD.	31			
19	NLV01 5W4	665.300	FND NORTH LAS VEGAS PIN AND PLATE IN TOP OF CURB, NORTHEAST CORNER OF CRAIG RD. AND ALLEN LN. NEAR THE PC OF CRAIG RD.	32			
20	7C01 6W6 1997	671.971	SET RIVET AND ROUND ALUMINUM PLATE IN TOP OF CURB, NORTHEAST CORNER OF CRAIG RD. AND SAN MATEO ST. NEAR THE PC OF CRAIG RD.	33			
21	NLV01 6W4	673.692	FND NORTH LAS VEGAS PIN AND PLATE IN TOP OF CURB, NORTHEAST CORNER OF CRAIG RD. AND DECATUR BLVD. NEAR THE PC OF CRAIG RD.	34			
22	NLV AP001	671.117	FND NORTH LAS VEGAS PIN AND PLATE IN TOP OF CURB, EAST SIDE OF RANCHO DR. IN THE NOSE OF AN ISLAND AT THE ENTRANCE TO THE NORTH LAS VEGAS AIRPORT. NOTE: IN 1992 BENCH BOOK POINT WAS ID NLV01 AP001.	35			
23	NLV AP002	668.508	FND RIVET AND SQUARE ALUMINUM PLATE IN CARD KEY BASE AT GATE #3 100' SOUTHEASTERLY FROM THE MAIN TERMINAL BUILDING.	CLARK COUNTY VERTICAL CONTROL v.2003 CLARK COUNTY SURVEYOR'S OFFICE 5051 SOUTH PARADISE ROAD LAS VEGAS, NEVADA 89119 (702) 455-0640			
24	NLV AP003	670.167	FND RIVET AND SQUARE ALUMINUM PLATE IN A TRANSFORMER PAD, 300' NORTHWESTERLY FROM THE MAIN TERMINAL BUILDING IN THE CORNER OF THE PARKING LOT.				
				CONVERSION FACTOR: METERS X $\left(\frac{3937}{1200}\right)$ = U.S. SURVEY FEET REVISED 2003 SHEET 2 OF 2 20-61 NW			