

# Township 20 South, Range 61 East Southeast Quarter

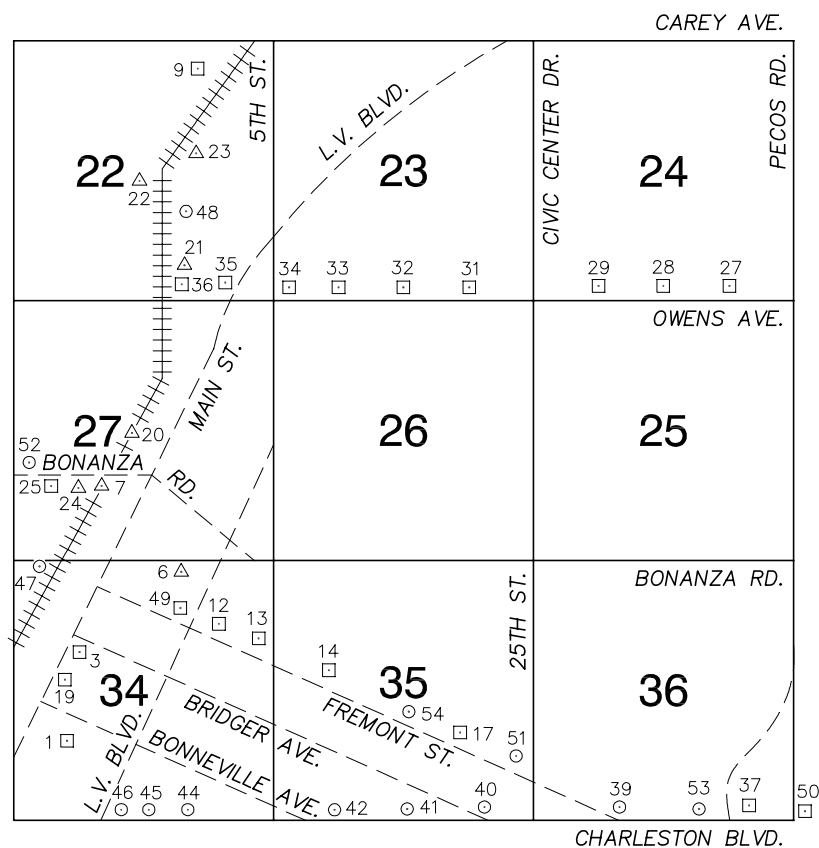

NORTH AMERICAN VERTICAL  
DATUM OF 1988  
— ALL ELEVATIONS IN METERS —

No.	STATION	ELEVATION (METERS)	DESCRIPTION
1	6C01 34SW6	617.855	F N D RIVET AND SQUARE ALUMINUM PLATE IN CONCRETE BASE OF A STREET LIGHT POLE, EAST SIDE OF MAIN ST. AND 245' SOUTHWEST OF BONNEVILLE AVE.
2			LOST 2003
3	6C01 34W6	617.378	F N D NDOT DOME HEAD BRASS CAP IN TOP OF CURB, SOUTHEAST CORNER OF MAIN ST. AND BRIDGER ST. NEAR PC OF MAIN ST.
4			LOST 2003
5			LOST 2003
6	K 169 1935	613.667	F N D USC&GS BRASS CAP, STAMPED "K169 1935", IN TOP OF THE EAST END OF THE STEPS AT THE POST OFFICE, 3RD ST. AND STEWART AVE.
7	P 314 1965	615.568	F N D USC&GS BRASS CAP, STAMPED "P314 1965", IN TOP OF RETAINING WALL, SOUTH EDGE OF BONANZA RD. AT UNDERPASS AT RAILROAD TRACK LEVEL.
8			LOST 2003
9	7C01 22NE6	590.387	F N D RIVET AND SQUARE ALUMINUM PLATE IN TOP OF CURB, NORTHEAST CORNER OF LOSEE RD. AND THE SOUTH END OF CRESTLINE LOOP.
10			LOST 2003
11			LOST 2003

## CLARK COUNTY VERTICAL CONTROL v.2003

CLARK COUNTY SURVEYOR'S OFFICE  
5051 SOUTH PARADISE ROAD  
LAS VEGAS, NEVADA 89119  
(702) 455-0640

CONVERSION FACTOR: METERS X $\left(\frac{3937}{1200}\right)$ = U.S. SURVEY FEET		
REVISED 2003	SHEET 1 OF 3	20-61 SE

No.	STATION	ELEVATION (METERS)	DESCRIPTION	No.	STATION	ELEVATION (METERS)	DESCRIPTION
12	6C01 34E6	610.236	F N D RIVET AND SQUARE ALUMINUM PLATE IN TOP OF CURB, NORTHWEST CORNER OF 7TH ST. AND FREMONT ST. NEAR THE PC OF FREMONT ST.	25	7C01 27SW6	620.698	F N D RIVET AND SQUARE ALUMINUM PLATE IN TOP OF NORTH SIDE OF BARRIER WALL FOR CENTERLINE SUPPORT PILLARS FOR FREEWAY OVERPASS AT BONANZA RD. AND 8' WEST OF CENTERLINE OF EAST PILLAR AND V398.
13	CLV 06135 B23	605.559	F N D CITY OF LAS VEGAS PIN AND PLATE IN TOP OF CURB, NORTHWEST CORNER OF 11TH ST. AND FREMONT ST. NEAR THE PC OF FREMONT ST.	26			LOST 2003
14	6C01 35SW6	588.229	F N D RIVET AND SQUARE ALUMINUM PLATE IN TOP OF CURB ACROSS FROM 1600 FREMONT ST.	27	7C01 24SSE6	555.406	F N D RIVET AND SQUARE ALUMINUM PLATE IN TOP OF CURB, NORTHEAST CORNER OF OWENS AVE. AND PALMER ST. NEAR THE PC OF OWENS AVE.
15			LOST 2003	28	7C01 24S4	557.239	F N D RIVET AND SQUARE ALUMINUM PLATE IN TOP OF CURB, NORTHEAST CORNER OF OWENS AVE. AND MOJAVE RD. NEAR A CROSSWALK SIGNAL POLE.
16			LOST 2003	29	7C01 24SSW6	559.766	F N D RIVET AND SQUARE ALUMINUM PLATE IN TOP OF CURB, NORTHEAST CORNER OF OWENS AVE. AND PATRICIA ST. NEAR THE PC OF OWENS AVE.
17	6C01 35SE6	572.582	F N D RIVET AND SQUARE ALUMINUM PLATE IN TOP OF CURB, NORTHWEST CORNER OF FREMONT ST. AND 21ST ST. NEAR THE PC OF FREMONT ST.	30			LOST 2003
18			LOST 2003	31	7C01 23SSE6	565.750	F N D RIVET AND SQUARE ALUMINUM PLATE IN TOP OF CURB, NORTHEAST CORNER OF OWENS AVE. AND McDANIEL ST. NEAR THE PC OF OWENS AVE.
19	CLV 06134B8	617.592	F N D CITY OF LAS VEGAS PIN AND PLATE, STAMPED "#06134B8", IN TOP OF CURB, NORTHEAST CORNER OF MAIN ST. AND LEWIS AVE. NEAR THE PC OF LEWIS AVE.	32	7C01 23S4	569.580	F N D RIVET AND SQUARE ALUMINUM PLATE IN TOP OF CURB, NORTHEAST CORNER OF OWENS AVE. AND BRUCE ST. NEAR THE PC OF OWENS AVE.
20	Z 399 1980	611.583	F N D USC&GS BRASS CAP, STAMPED "Z399 1980", SET IN SIDEWALK JUST WEST OF RAILROAD TRACKS IN SOUTH END OF A BRIDGE OVER WASHINGTON AVE. AND WEST OF MAIN ST.	33	7C01 23SSW6	575.682	F N D RIVET AND SQUARE ALUMINUM PLATE IN TOP OF CURB, NORTHEAST CORNER OF OWENS AVE. AND WOODARD ST. NEAR THE PC OF OWENS AVE.
21	N 399 1980	602.624	F N D USC&GS BRASS CAP, STAMPED "N399 1980", IN TOP OF ABUTMENT, NORTHEAST CORNER OF A RAILROAD BRIDGE OVER OWENS AVE. AND WEST OF LAS VEGAS BLVD.	34	7C01 23SWS	579.190	F N D RIVET AND SQUARE ALUMINUM PLATE IN TOP OF CURB, NORTHEAST CORNER OF OWENS AVE. AND LAS VEGAS BLVD. NEAR THE PC OF OWENS AVE.
22	P 399 1980	595.949	F N D USC&GS BRASS CAP IN TOP OF CONCRETE BARRIER WALL WEST SIDE OF RAILROAD TRACKS ON THE NORTH SIDE OF LAKE MEAD BLVD. AT THE NORTHWEST CORNER OF A RAILROAD BRIDGE GOING OVER LAKE MEAD BLVD.	35	7C01 22SSE6	585.446	F N D RIVET AND SQUARE ALUMINUM PLATE IN TOP OF CURB, NORTHEAST CORNER OF OWENS AVE. AND DAVIS PL. NEAR THE PC OF OWENS AVE.
23	V 170 1935	592.398	F N D USC&GS BRASS CAP IN TOP OF SOUTHEAST ABUTMENT OF RAILROAD BRIDGE OVER A DRAINAGE DITCH RUNNING EAST FROM LOSEE RD. AT MILLER AVE.	<b>CLARK COUNTY VERTICAL CONTROL v.2003</b>  CLARK COUNTY SURVEYOR'S OFFICE 5051 SOUTH PARADISE ROAD LAS VEGAS, NEVADA 89119 (702) 455-0640			
24	V 398 1980	621.258	F N D USC&GS BRASS CAP, STAMPED "V398 1980", SET VERTICALLY IN EAST FACE OF EAST FREEWAY SUPPORT PILLAR NEAR THE CENTERLINE OF BONANZA RD. POINT APPEARS TO HAVE BEEN VANDALIZED.				
				CONVERSION FACTOR: METERS X $\left(\frac{3937}{1200}\right)$ = U.S. SURVEY FEET  REVISED 2003      SHEET 2 OF 3 <b>20-61 SE</b>			

No.	STATION	ELEVATION (METERS)	DESCRIPTION	No.	STATION	ELEVATION (METERS)	DESCRIPTION
36	7C01 22S4	596.674	FND RIVET AND SQUARE ALUMINUM PLATE IN TOP OF CURB, NORTH SIDE OF OWENS AVE. AT THE EAST FACE OF AND UNDER THE RAILROAD BRIDGE CROSSING OWENS AVE.	49	CLV FREMONT 5	611.759	FND CITY OF LAS VEGAS PIN AND PLATE IN TOP OF CURB, NORTHEAST CORNER OF FREMONT ST. AND LAS VEGAS BLVD. NEAR THE PC OF LAS VEGAS BLVD.
37	6C01 36SSE6	552.918	FND RIVET AND SQUARE ALUMINUM PLATE IN TOP OF CURB, NORTHEAST CORNER OF CHARLESTON BLVD. AND PECOS RD./PALM ST. AT RANGE LINE TO SOUTH NEAR THE PC OF CHARLESTON BLVD.	50	2LV01 36SSE6	550.460	FND CITY OF LAS VEGAS PIN AND PLATE IN TOP OF CURB, IN THE NORTHEAST CORNER OF PECOS ST. AND CHARLESTON BLVD. NEAR THE PC OF CHARLESTON BLVD.
38			LOST 2003	51	GIS 826	567.195	FND 2" BRASS CAP IN TOP OF CURB, WEST SIDE OF 25TH ST. AND 100' NORTH OF CHARLESTON BLVD.
39	LV01 36SSW6	562.133	FND CITY OF LAS VEGAS PIN AND PLATE IN TOP OF CURB, NORTHWEST CORNER OF 28TH ST. AND CHARLESTON BLVD. NEAR THE PC OF CHARLESTON BLVD. "NOT STAMPED"	52	2LV01 27SWW6	620.291	FND CITY OF LAS VEGAS PIN AND PLATE IN TOP OF CURB, NORTHEAST CORNER OF BONANZA RD. AND "H" ST. NEAR 1/2 DELTA.
40	OLV01 35SESA	570.898	FND CITY OF LAS VEGAS PIN AND PLATE IN TOP OF CURB, NORTHWEST CORNER OF CHARLESTON BLVD. AND EASTERN AVE. NEAR THE PC OF CHARLESTON BLVD. "DEFACED"	53	2LV01 36S4	556.496	FND CITY OF LAS VEGAS PIN AND PLATE IN TOP OF CURB, NORTHWEST CORNER OF MOJAVE RD. AND CHARLESTON BLVD. NEAR THE PC OF CHARLESTON BLVD.
41	2LV01 35S4	579.048	FND CITY OF LAS VEGAS PIN AND PLATE IN TOP OF CURB, NORTHEAST CORNER OF CHARLESTON BLVD. AND BRUCE ST. NEAR 1/2 DELTA.	54	7C01 35S6 1997	580.731	SET RIVET AND ROUND ALUMINUM PLATE IN TOP OF CURB, NORTHWEST CORNER OF FREMONT ST. AND BRUCE ST. NEAR THE PC OF FREMONT ST.
42	2LV01 35SSW6	587.134	FND CITY OF LAS VEGAS PIN AND PLATE IN TOP OF CURB, NORTHEAST CORNER OF CHARLESTON BLVD. AND 17TH ST. NEAR 1/2 DELTA.	55			
43			LOST 2003	56			
44	2LV01 34SSE6	602.829	FND CITY OF LAS VEGAS PIN AND PLATE IN TOP OF CURB, NORTHEAST CORNER OF CHARLESTON AND MARYLAND PKWY. NEAR 1/2 DELTA.	57			
45	CHAS. 10	609.559	FND CITY OF LAS VEGAS PIN AND PLATE IN TOP OF CURB, NORTHEAST CORNER OF CHARLESTON BLVD. AND 10TH ST. NEAR THE PC OF CHARLESTON BLVD.	58			
46	CHAS. 5	615.618	FND CITY OF LAS VEGAS PIN AND PLATE IN TOP OF CURB, NORTHEAST CORNER OF CHARLESTON BLVD. AND LAS VEGAS BLVD. NEAR 1/4 DELTA.	59			
47	7C01 34NNW6 1997	617.808	SET RIVET AND ROUND ALUMINUM PLATE IN TOP OF CURB, ON TOP OF THE OGDEN OVERPASS, FOR THE U.P.R.R. WEST OF THE TRACKS.	<b>CLARK COUNTY VERTICAL CONTROL v.2003</b>  CLARK COUNTY SURVEYOR'S OFFICE 5051 SOUTH PARADISE ROAD LAS VEGAS, NEVADA 89119 (702) 455-0640			
48	7C01 22SE6 1997	598.152	SET RIVET AND ROUND ALUMINUM PLATE IN THE NORTHEAST ABUTMENT OF A RAILROAD BRIDGE OVER FREEWAY AND NORTH OF FREEWAY AND EAST OF TRACKS.				
				CONVERSION FACTOR: METERS X $\left(\frac{3937}{1200}\right)$ = U.S. SURVEY FEET  REVISED 2003      SHEET 3 OF 3 <b>20-61 SE</b>			