

Township 21 South, Range 58 East Northeast Quarter

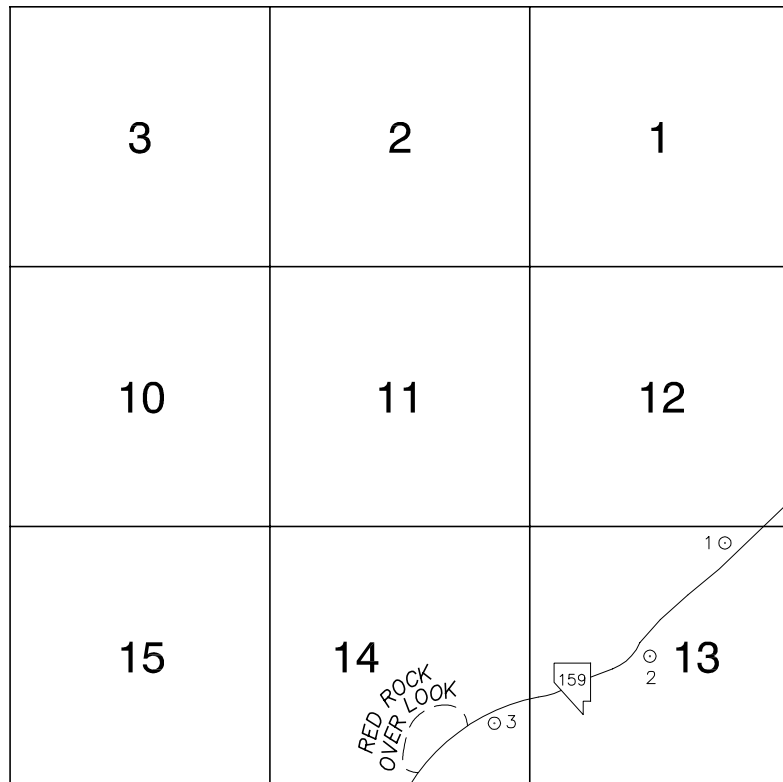

NORTH AMERICAN VERTICAL
DATUM OF 1988
- ALL ELEVATIONS IN METERS -

No.	STATION	ELEVATION (METERS)	DESCRIPTION
1	8C18 13NNE6 1998	1132.311	F N D NDOT BRASS CAP IN CONCRETE, 50' NORTHWEST OF CENTERLINE OF STATE ROUTE 159, 1.3 MILES NORTHEAST OF REDROCK OVERLOOK, NDOT STATION E 545+89 PT.
2	8C18 13C4 1998	1125.789	F N D NDOT BRASS CAP IN CONCRETE, 50' SOUTHEAST OF CENTERLINE OF STATE ROUTE 159, 0.8 MILES NORTHEAST OF REDROCK OVERLOOK, NDOT STATION E 519+59.49 PT.
3	8C18 14SEE6 1998	1162.571	F N D NDOT BRASS CAP IN CONCRETE, 50' SOUTH OF CENTERLINE OF STATE ROUTE 159, 650' NORTHEAST OF RED ROCK OVERLOOK, NDOT STATION E 485+25.55 PT.
4			
5			
6			
7			
8			
9			
10			
11			

CLARK COUNTY VERTICAL CONTROL v.2003

CLARK COUNTY SURVEYOR'S OFFICE
5051 SOUTH PARADISE ROAD
LAS VEGAS, NEVADA 89119
(702) 455-0640

CONVERSION FACTOR:
METERS X $\left(\frac{3937}{1200}\right)$ = U.S. SURVEY FEET

REVISED 2003

SHEET
1 of 1

21-58
NE