

Township 21 South, Range 60 East Southwest Quarter

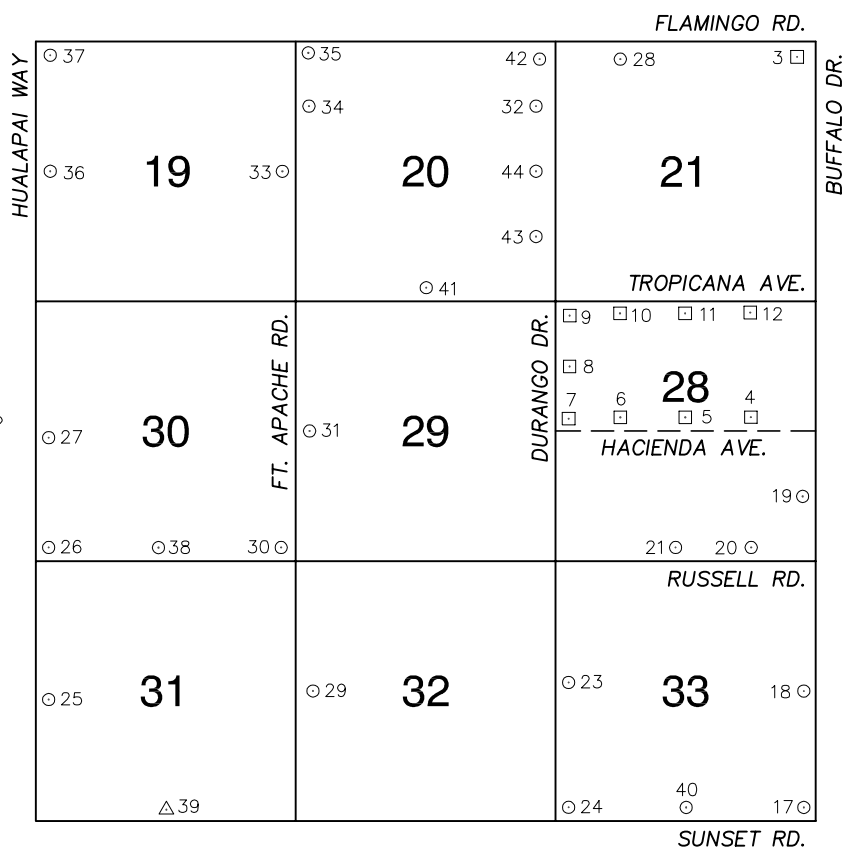

NORTH AMERICAN VERTICAL
DATUM OF 1988
- ALL ELEVATIONS IN METERS -

No.	STATION	ELEVATION (METERS)	DESCRIPTION
1			LOST 2003
2			LOST 2003
3	7C10 21NES	747.152	F N D RIVET AND SQUARE ALUMINUM PLATE IN CONCRETE FOUNDATION OF ELECTRICAL CABINET, SOUTHWEST CORNER OF BUFFALO DR. AND FLAMINGO RD.
4	2C10 28E6	741.766	F N D RIVET AND SQUARE ALUMINUM PLATE IN TOP OF CURB, NORTH SIDE OF HACIENDA AVE. 0.25 MILES WEST OF BUFFALO DR.
5	2C10 28C4	746.991	F N D RIVET AND SQUARE ALUMINUM PLATE IN TOP OF CURB, NORTH SIDE OF HACIENDA AVE. AT CIMARRON RD.
6	2C10 28W6	752.816	F N D RIVET AND SQUARE ALUMINUM PLATE IN TOP OF CURB, NORTH SIDE OF HACIENDA AVE. 0.26 MILES EAST OF DURANGO DR.
7	2C10 28W4	759.744	F N D RIVET AND SQUARE ALUMINUM PLATE IN TOP OF CURB, NORTHEAST CORNER OF HACIENDA AVE. AND DURANGO DR. AT 1/2 DELTA.
8	2C10 28NWW6	763.305	F N D RIVET AND SQUARE ALUMINUM PLATE IN TOP OF CURB, EAST SIDE OF DURANGO DR. NEAR RENO AVE.
9	2C10 28NWS	765.607	F N D RIVET AND SQUARE ALUMINUM PLATE IN TOP OF CURB, SOUTH SIDE OF TROPICANA AVE. AND 200' EAST OF DURANGO DR.
10	2C10 28NNW6	759.357	F N D RIVET AND SQUARE ALUMINUM PLATE IN TOP OF CURB, SOUTH SIDE OF TROPICANA AVE AND 0.25 MILES EAST OF DURANGO DR.
11	2C10 28N4	752.145	F N D RIVET AND SQUARE ALUMINUM PLATE IN TOP OF CURB, SOUTH SIDE OF TROPICANA AVE. NEAR CIMARRON RD. ALIGNMENT.
CLARK COUNTY VERTICAL CONTROL v.2003			
CLARK COUNTY SURVEYOR'S OFFICE 5051 SOUTH PARADISE ROAD LAS VEGAS, NEVADA 89119 (702) 455-0640			CONVERSION FACTOR: METERS X $\left(\frac{3937}{1200}\right)$ = U.S. SURVEY FEET
REVISED 09/01/2006		SHEET 1 OF 3	21-60 SW

No.	STATION	ELEVATION (METERS)	DESCRIPTION	No.	STATION	ELEVATION (METERS)	DESCRIPTION
12	2C10 28NNE6	744.840	F N D RIVET AND SQUARE ALUMINUM PLATE IN TOP OF CURB, SOUTH SIDE OF TROPICANA AVE. AND 0.25 MILES WEST OF BUFFALO DR.	25	8C10 31W4 1998	813.443	S E T RIVET AND ROUND ALUMINUM PLATE IN A LVVWD (AIR-VAC) VENT CONCRETE PAD, IN THE SOUTHEAST QUADRANT OF HUALAPAI WAY AND PATRICK LN. 135' SOUTH AND 48' EAST OF THE INTERSECTION.
13			LOST 2003	26	8C10 30SWS 1998	819.445	S E T RIVET AND ROUND ALUMINUM PLATE IN A CONCRETE MONUMENT, NORTHEAST QUADRANT OF HUALAPAI WAY AND RUSSELL RD. 135' EAST AND 66' NORTH OF THE INTERSECTION.
14			LOST 2003	27	8C10 30W4 1998	834.032	S E T RIVET AND ROUND ALUMINUM PLATE IN A CONCRETE MONUMENT, SOUTHEAST QUADRANT OF HUALAPAI WAY AND HACIENDA AVE. 83' SOUTH AND 101' EAST OF THE INTERSECTION.
15			LOST 2003	28	8C10 21NNW6 1998	770.630	S E T RIVET AND ROUND ALUMINUM PLATE IN TOP OF CURB, SOUTHWEST CORNER OF FLAMINGO RD. AND GAGNIER BLVD. NEAR THE PC OF FLAMINGO RD.
16			LOST 2003	29	8C10 32W4 1998	782.600	S E T RIVET AND ROUND ALUMINUM PLATE IN A CONCRETE MONUMENT, NORTHEAST CORNER OF FORT APACHE RD. AND PATRICK LN.
17	8C10 33SES 1998	767.458	S E T RIVET AND ROUND ALUMINUM PLATE IN A LVVWD (AIR-VAC) VENT CONCRETE PAD, IN THE NORTHWEST QUADRANT OF BUFFALO DR. AND SUNSET RD. 46' WEST AND 134' NORTH OF THE INTERSECTION.	30	8C10 30SES 1998	790.636	S E T RIVET AND ROUND ALUMINUM PLATE IN A CONCRETE MONUMENT, NORTHWEST CORNER OF FORT APACHE RD. AND RUSSELL RD. 47' NORTH AND 110' WEST
18	8C10 33E4 1998	757.773	S E T RIVET AND ROUND ALUMINUM PLATE IN A CONCRETE MONUMENT, NORTHWEST QUADRANT OF PATRICK LN. AND BUFFALO DR. 57' WEST AND 43' NORTH OF THE INTERSECTION.	31	8C10 29W4 1998	795.269	S E T RIVET AND ROUND ALUMINUM PLATE IN A CONCRETE MONUMENT, SOUTHEAST CORNER OF FORT APACHE RD. AND HACIENDA AVE.
19	8C10 28SEE6 1998	741.693	S E T RIVET AND ROUND ALUMINUM PLATE IN TOP OF CURB, NORTHWEST CORNER OF BUFFALO DR. AND DIABLO DR. NEAR THE PC OF BUFFALO DR.	32	0C10 20NEE6 2000	775.616	S E T RIVET AND ROUND ALUMINUM PLATE IN TOP OF CURB, SOUTHWEST CORNER OF DURANGO DR. AND ROCHELLE AVE. NEAR THE PC OF DURANGO DR.
20	8C10 28SSE6 1998	750.084	S E T RIVET AND ROUND ALUMINUM PLATE IN TOP OF CURB, NORTH SIDE OF RUSSELL RD. NEAR THE ALIGNMENT OF WARBONNET WAY.	33	8C10 19E4 1998	800.514	S E T RIVET AND ROUND ALUMINUM PLATE IN A CONCRETE ELECTRICAL VAULT, SOUTHWEST CORNER OF FORT APACHE RD. AND PEACE WAY.
21	8C10 28S4 1998	753.149	S E T RIVET AND ROUND ALUMINUM PLATE IN THE SOUTHEAST CORNER OF A CONCRETE ELECTRICAL VAULT 13' X 34' NORTH OF RUSSELL RD. 290' WEST OF E.O. AND 100' EAST OF THE EAST SLOPE OF THE DETENTION BASIN.	34	8C10 20NWW6 1998	803.657	S E T RIVET AND ROUND ALUMINUM PLATE IN TOP OF CURB, NORTHEAST CORNER OF FORT APACHE RD. AND ROCHELLE AVE. NEAR THE PC OF FORT APACHE RD.
22			LOST 2006	35	8C10 20NWS 1998	807.055	S E T RIVET AND ROUND ALUMINUM PLATE IN A CONCRETE ELECTRICAL VAULT, SOUTHEAST CORNER OF FORT APACHE RD. AND FLAMINGO RD. 190' EAST OF FORT APACHE RD.
23	8C10 33W4 1998	769.022	S E T RIVET AND ROUND ALUMINUM PLATE IN THE SOUTHWEST CORNER OF A CONCRETE ELECTRICAL VAULT 13' X 34' 30' EAST OF THE EO OF DURANGO DR. AND 100' NORTH OF THE ALIGNMENT OF PATRICK LN.	CLARK COUNTY VERTICAL CONTROL v.2003 CLARK COUNTY SURVEYOR'S OFFICE 5051 SOUTH PARADISE ROAD LAS VEGAS, NEVADA 89119 (702) 455-0640			
24	8C10 33SWS 1998	781.751	S E T RIVET AND ROUND ALUMINUM PLATE IN A CONCRETE ELECTRICAL VAULT, NORTHEAST QUADRANT OF SUNSET RD. AND DURANGO DR.				
				CONVERSION FACTOR: METERS X $\left(\frac{3937}{1200}\right)$ = U.S. SURVEY FEET REVISED 09/01/2006			
				SHEET 2 OF 3 21-60 SW			

No.	STATION	ELEVATION (METERS)	DESCRIPTION	No.	STATION	ELEVATION (METERS)	DESCRIPTION
36	8C10 19W4 1998	834.674	S E T RIVET AND ROUND ALUMINUM PLATE IN A CONCRETE MONUMENT, SOUTHEAST CORNER OF HUALAPAI WAY AND HARMON AVE. 70' SOUTH AND 150' EAST.	49			
37	0C10 19NWS 2000	837.677	S E T RIVET AND ROUND ALUMINUM PLATE IN AN ELECTRICAL TRANSFORMER PAD, 40' SOUTH OF FLAMINGO RD. AND 150' EAST OF HUALAPAI WAY.	50			
38	8C10 30S4 1998	807.986	S E T RIVET AND ROUND ALUMINUM PLATE IN A CONCRETE MONUMENT, NORTHWEST CORNER OF RUSSELL RD. AND GRAND CANYON DR. 180' WEST AND 50' NORTH.	51			
39	GIS 841	790.718	F N D 2" BRASS CAP IN A CONCRETE MONUMENT, NORTHWEST CORNER OF SUNSET RD. AND GRAND CANYON DR. STAMPED "GIS 841 RLS 4743".	52			
40	8C10 33S4 1998	775.423	S E T RIVET AND ROUND ALUMINUM PLATE IN A CONCRETE MONUMENT, NORTHEAST CORNER OF SUNSET RD. AND CIMARRON RD.	53			
41	8C10 20S4 1998	779.486	S E T RIVET AND ROUND ALUMINUM PLATE IN TOP OF CURB, NORTHEAST CORNER OF TROPICANA AVE. AND EL CAPITAN WAY. NEAR THE PC OF TROPICANA AVE.	54			
42	8C10 20NES 1998	778.533	S E T RIVET AND ROUND ALUMINUM PLATE IN TOP OF CURB, SOUTHWEST CORNER OF DURANGO DR. AND FLAMINGO RD. NEAR THE PC OF FLAMINGO DR.	55			
43	8C10 20SEE6 1998	769.767	S E T RIVET AND ROUND ALUMINUM PLATE IN TOP OF CURB, WEST SIDE OF DURANGO DR. 37' NORTH OF THE ALIGNMENT OF TOMPKINS AVE.	56			
44	8C10 20E4 1998	771.713	S E T RIVET AND ROUND ALUMINUM PLATE IN TOP OF CURB, SOUTHWEST CORNER OF DURANGO DR. AND PEACE WAY NEAR THE PC OF DURANGO DR.	57			
45				58			
46				59			
47				CLARK COUNTY VERTICAL CONTROL v.2003			
48				<div>CLARK COUNTY SURVEYOR'S OFFICE 5051 SOUTH PARADISE ROAD LAS VEGAS, NEVADA 89119 (702) 455-0640</div> <div>CONVERSION FACTOR: METERS X $\left(\frac{3937}{1200}\right)$ = U.S. SURVEY FEET</div> <div>REVISED 2003</div>			
						SHEET 3 OF 3	21-60 SW