

Township 21 South, Range 61 East Northwest Quarter

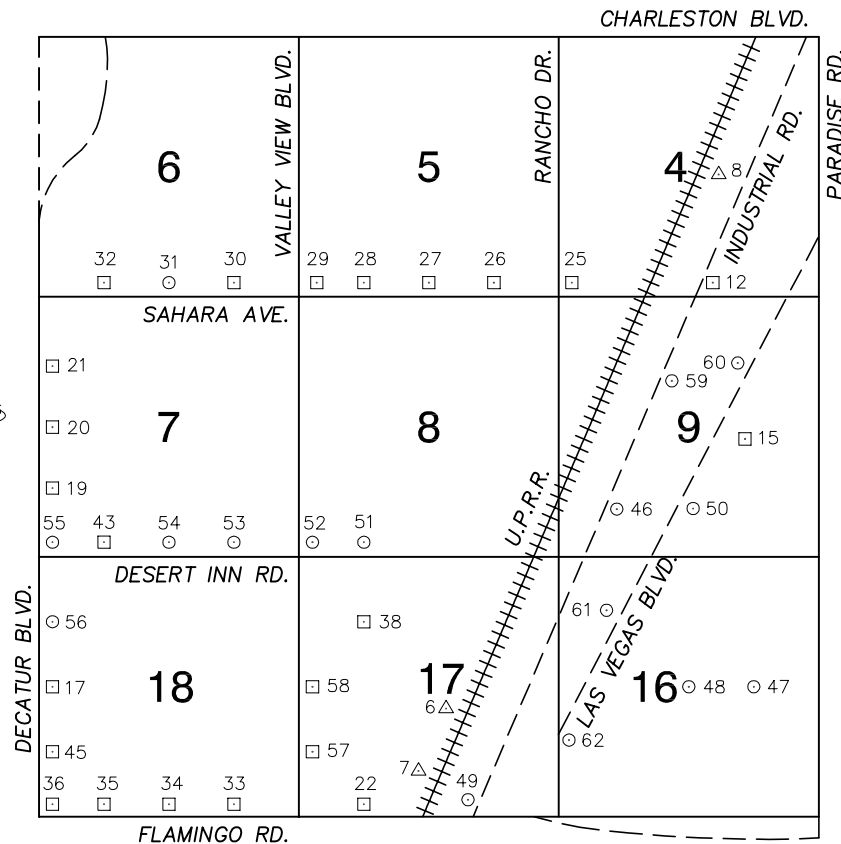

NORTH AMERICAN VERTICAL
DATUM OF 1988
- ALL ELEVATIONS IN METERS -

No.	STATION	ELEVATION (METERS)	DESCRIPTION
1			LOST 2003
2			LOST 2003
3			LOST 2003
4			LOST 2003
5			LOST 2003
6	W 399 1980	648.204	F N D USC&GS BRASS CAP SET VERTICALLY IN EAST FACE OF SOUTH SUPPORT PILLAR OF SOUTH BOUND I-15 OVERPASS AT RAILROAD TRACKS, FIRST COLUMN WEST OF TRACKS.
7	N 366 1963	653.516	F N D USC&GS BRASS CAP IN SOUTHEAST HEADWALL OF RAILROAD BRIDGE, 325' NORTH OF FLAMINGO RD. OVERPASS AT TRACKS.
8	K 366 1963	623.990	F N D USC&GS BRASS CAP IN NORTHEAST CORNER OF OAKY BLVD.-WYOMING AVE. AND U.P.R.R. TRACKS, IN TOP OF WEST END OF RETAINING WALL.
9			LOST 2003
10			LOST 2003
11			LOST 2003

CLARK COUNTY VERTICAL CONTROL v.2003

CLARK COUNTY SURVEYOR'S OFFICE
5051 SOUTH PARADISE ROAD
LAS VEGAS, NEVADA 89119
(702) 455-0640

CONVERSION FACTOR:
METERS X $\left(\frac{3937}{1200}\right)$ = U.S. SURVEY FEET

REVISED
09/01/2006

SHEET
1 OF 4

21-61
NW

No.	STATION	ELEVATION (METERS)	DESCRIPTION		No.	STATION	ELEVATION (METERS)	DESCRIPTION	
12	6C11 4S4	626.252	F N D	RIVET AND SQUARE ALUMINUM PLATE IN TOP OF CURB, EAST SIDE OF INDUSTRIAL RD. JUST NORTH OF SAHARA AVE. OVERPASS NEAR THE PC OF NORTH BRIDGE ST.	25	7C11 4SWS	632.656	F N D	RIVET AND SQUARE ALUMINUM PLATE IN TOP OF CURB, NORTHEAST CORNER OF SAHARA AVE. AND RANCHO DR. NEAR THE PC OF SAHARA AVE.
13				LOST 2003	26	7C11 5SSE6	636.825	F N D	RIVET AND SQUARE ALUMINUM PLATE IN TOP OF CURB, NORTHEAST CORNER OF SAHARA AVE. AND PASEO DEL PRADO—TEDDY DR. NEAR THE PC OF SAHARA AVE.
14				LOST 2003	27	7C11 5S4	640.447	F N D	RIVET AND SQUARE ALUMINUM PLATE IN TOP OF CURB, NORTHEAST CORNER OF SAHARA AVE. AND RICHFIELD BLVD. NEAR THE PC OF SAHARA AVE.
15	6C11 9E6	627.908	F N D	RIVET AND SQUARE ALUMINUM PLATE IN A TRAFFIC SIGNAL POLE BASE, SOUTHEAST CORNER OF RIVIERA BLVD. AND LAS VEGAS BLVD.	28	7C11 5SSW6	649.768	F N D	RIVET AND SQUARE ALUMINUM PLATE IN TOP OF CURB, NORTHEAST CORNER OF SAHARA AVE. AND RYE ST. — SPANISH OAKS DR. NEAR THE PC OF SAHARA AVE.
16				LOST 2003	29	7C11 5SWS	657.619	F N D	RIVET AND SQUARE ALUMINUM PLATE IN TOP OF CURB, NORTHEAST CORNER OF SAHARA AVE. AND VALLEY VIEW BLVD. NEAR THE PC OF SAHARA AVE.
17	7C11 18W4	676.537	F N D	RIVET AND SQUARE ALUMINUM PLATE IN TOP OF CURB, NORTHEAST CORNER OF DECATUR BLVD. AND TWAIN AVE. NEAR THE PC OF DECATUR BLVD.	30	7C11 6SSE6	660.636	F N D	RIVET AND SQUARE ALUMINUM PLATE IN TOP OF CURB, NORTHEAST CORNER OF SAHARA AVE. AND ARENAS ST. NEAR THE PC OF SAHARA AVE.
18				LOST 2003	31	7C11 6S4	665.299	F N D	NDOT BRASS CAP IN TOP OF CURB, NORTHWEST CORNER OF SAHARA AVE. AND ARVILLE ST. NEAR THE PC OF SAHARA AVE.
19	7C11 7SSW6	674.393	F N D	RIVET AND SQUARE ALUMINUM PLATE IN TOP OF CURB, NORTHEAST CORNER OF DECATUR BLVD. AND SIRIUS AVE. NEAR THE PC OF DECATUR BLVD.	32	2LV11 6SSW6	669.693	F N D	CITY OF LAS VEGAS PIN AND PLATE IN TOP OF CURB, NORTH SIDE OF SAHARA AVE. AT DECATUR PLAZA, NEAR 4601 SAHARA AVE.
20	CLV 1617B14	676.560	F N D	CITY OF LAS VEGAS PIN AND PLATE IN TOP OF CURB, NORTHEAST CORNER OF DECATUR BLVD. AND PENNWOOD AVE. (EDNA AVE. WESTERLY) NEAR THE PC OF DECATUR BLVD.	33	7C11 18SSE6	663.961	F N D	RIVET AND SQUARE ALUMINUM PLATE IN TOP OF CURB, NORTHEAST CORNER OF FLAMINGO RD. AND WYNN RD. NEAR THE PC OF FLAMINGO RD.
21	CLV 1617B15	676.138	F N D	CITY OF LAS VEGAS PIN AND PLATE IN TOP OF CURB, SOUTHEAST CORNER OF DECATUR BLVD. AND ELDORA AVE. NEAR THE PC OF DECATUR BLVD.	34	7C11 18S4	668.173	F N D	RIVET AND SQUARE ALUMINUM PLATE IN TOP OF CURB, NORTHEAST CORNER OF FLAMINGO RD. AND ARVILLE ST. NEAR THE PC OF FLAMINGO RD.
22	7C11 17SSW6	653.350	F N D	RIVET AND SQUARE ALUMINUM PLATE IN NORTHEAST CORNER OF CONCRETE FOUNDATION OF DOUBLE POWERLINE AT NORTH POLE #FL 6 AT NORTHEAST CORNER OF FLAMINGO RD. AND HIGHLAND DR.	35	7C11 18SSW6	672.823	F N D	RIVET AND SQUARE ALUMINUM PLATE IN TOP OF CURB, NORTHWEST CORNER OF FLAMINGO RD. BETWEEN CAMERON ST. AND CALLE SAN REMO DR. NEAR THE PC OF CAMERON ST.
23				LOST 2003	CLARK COUNTY VERTICAL CONTROL v.2003 CLARK COUNTY SURVEYOR'S OFFICE 5051 SOUTH PARADISE ROAD LAS VEGAS, NEVADA 89119 (702) 455-0640				
24				LOST 2003					
					CONVERSION FACTOR: METERS X $\left(\frac{3937}{1200}\right)$ = U.S. SURVEY FEET REVISED 09/01/2006				
					SHEET 2 OF 4		21-61 NW		

No.	STATION	ELEVATION (METERS)	DESCRIPTION	No.	STATION	ELEVATION (METERS)	DESCRIPTION
36	7C11 18SWS	678.353	F N D RIVET AND SQUARE ALUMINUM PLATE IN TOP OF CURB, NORTHEAST CORNER OF FLAMINGO RD. AND DECATUR BLVD. NEAR THE PC OF FLAMINGO RD.	49	0C11 17S4 2000	651.611	S E T RIVET AND ROUND ALUMINUM PLATE IN TOP OF CURB, WEST SIDE OF INDUSTRIAL RD. 100' NORTH OF THE FLAMINGO RD. OVERPASS.
37			LOST 2003	50	0C11 9S6 2000	630.998	S E T RIVET AND ROUND ALUMINUM PLATE IN TOP OF CURB, NORTHEAST CORNER OF CATHEDRAL WAY AND LAS VEGAS BLVD. NEAR THE PC OF CATHEDRAL WAY.
38	7C11 17NW6	651.332	F N D RIVET AND SQUARE ALUMINUM PLATE IN TOP OF CURB, NORTHEAST CORNER OF SPRING MOUNTAIN RD. AND POLARIS AVE. NEAR PC OF SPRING MOUNTAIN RD.	51	0LV11 8SSW6	650.407	F N D CITY OF LAS VEGAS PIN AND PLATE IN TOP OF CURB, NORTHEAST CORNER OF DESERT INN RD. AND POLARIS AVE. (NOT STAMPED) NEAR THE PC OF DESERT INN RD.
39			LOST 2003	52	0LV11 8SWS	655.383	F N D CITY OF LAS VEGAS PIN AND PLATE IN TOP OF CURB, NORTHEAST CORNER OF DESERT INN RD. AND VALLEY VIEW BLVD. NEAR THE PC OF DESERT INN RD. (NOT STAMPED)
40			LOST 2003	53	0LV11 7SSE6	659.622	F N D CITY OF LAS VEGAS PIN AND PLATE IN TOP OF CURB, NORTHEAST CORNER OF DESERT INN RD. AND WYNN RD. NEAR THE PC OF DESERT INN RD. (NOT STAMPED)
41			LOST 2003	54	0LV11 7S4	663.799	F N D CITY OF LAS VEGAS PIN AND PLATE IN TOP OF CURB, NORTHEAST CORNER OF DESERT INN RD. AND ARVILLE ST. NEAR THE PC OF DESERT INN RD. (NOT STAMPED)
42			LOST 2003	55	0LV11 7SWS	675.496	F N D CITY OF LAS VEGAS PIN AND PLATE IN TOP OF CURB, NORTHEAST CORNER OF DECATUR BLVD. AND DESERT INN RD. NEAR THE PC OF DESERT INN RD. (NOT STAMPED)
43	7C11 7SSW6	669.024	F N D RIVET AND SQUARE ALUMINUM PLATE IN TOP OF CURB, NORTHEAST CORNER OF DESERT INN RD. AND CAMERON ST. NEAR THE PC OF DESERT INN RD.	56	0C11 18NWW6 2000	677.615	S E T RIVET AND ROUND ALUMINUM PLATE IN TOP OF CURB, NORTHEAST CORNER OF SPRING MOUNTAIN RD. AND DECATUR BLVD. NEAR THE PC OF DECATUR BLVD.
44			LOST 2003	57	7C11 17SWW6	660.516	F N D RIVET AND SQUARE ALUMINUM PLATE IN TOP OF CURB, NORTHEAST CORNER OF VALLEY VIEW BLVD. AND VIKING RD. NEAR THE PC OF VALLEY VIEW BLVD.
45	7C11 18SWW6	677.678	F N D RIVET AND SQUARE ALUMINUM PLATE IN TOP OF CURB, SOUTHEAST CORNER OF DECATUR BLVD. AND SUPAI DR.	58	7C11 17W4	658.113	F N D RIVET AND SQUARE ALUMINUM PLATE IN TOP OF CURB, NORTHEAST CORNER OF VALLEY VIEW BLVD. AND TWAIN AVE. NEAR THE PC OF VALLEY VIEW BLVD.
46	7C11 9SWW6 1997	637.459	S E T RIVET AND ROUND ALUMINUM PLATE IN TOP OF CURB, NORTHEAST CORNER OF INDUSTRIAL RD. AND STARDUST RD. NEAR THE PC OF INDUSTRIAL RD.	59	7C11 9NW6 1997	630.346	S E T RIVET AND ROUND ALUMINUM PLATE IN TOP OF CURB, NORTHEAST CORNER OF INDUSTRIAL RD. AND CIRCUS-CIRCUS DR. NEAR THE PC OF INDUSTRIAL RD.
47	8C11 16E6 1998	627.978	S E T RIVET AND ROUND ALUMINUM PLATE IN TOP OF CURB, NORTH SIDE OF SANDS AVE. AT MANHATTAN ST. 21 EAST OF THE PI OF MANHATTAN ST.	CLARK COUNTY VERTICAL CONTROL v.2003 CLARK COUNTY SURVEYOR'S OFFICE 5051 SOUTH PARADISE ROAD LAS VEGAS, NEVADA 89119 (702) 455-0640			
48	8C11 16C4 1998	632.008	S E T RIVET AND ROUND ALUMINUM PLATE IN TOP OF CURB, NORTH SIDE OF SANDS AVE. AT KOVAL LANE.				
				CONVERSION FACTOR: METERS X $\left(\frac{3937}{1200}\right)$ = U.S. SURVEY FEET REVISED 09/01/2006			
				SHEET 3 OF 4 21-61 NW			

No.	STATION	ELEVATION (METERS)	DESCRIPTION	No.	STATION	ELEVATION (METERS)	DESCRIPTION
60	5C11 9NE6	625.372	S E T RIVET AND ROUND ALUMINUM PLATE IN TOP OF CURB, NORTHWEST CORNER OF LAS VEGAS BLVD AND SOUTH ENTRANCE TO HILTON GRAND VACATION CLUB, NEAR THE PC OF LAS VEGAS BLVD. ± 1600' SOUTH OF SAHARA.				
61	5C11 16NW6	632.797	S E T RIVET AND ROUND ALUMINUM PLATE IN TOP OF CURB, EAST SIDE OF LAS VEGAS BLVD, ± 400' NORTH OF FASHON SHOW DRIVE.				
62	5C11 16SWW6	641.707	S E T RIVET AND ROUND ALUMINUM PLATE IN TOP OF CURB, EAST SIDE OF LAS VEGAS BLVD. IN FRONT OF 3555 LAS VEGAS BLVD. (OSHEAS CASAINO).				
				CLARK COUNTY VERTICAL CONTROL v.2003			
				CLARK COUNTY SURVEYOR'S OFFICE 5051 SOUTH PARADISE ROAD LAS VEGAS, NEVADA 89119 (702) 455-0640			
				CONVERSION FACTOR: METERS X $\left(\frac{3937}{1200}\right)$ = U.S. SURVEY FEET		REVISED 09/01/2006	SHEET 4 OF 4
							21-61 NW