

Township 21 South, Range 62 East Northwest Quarter

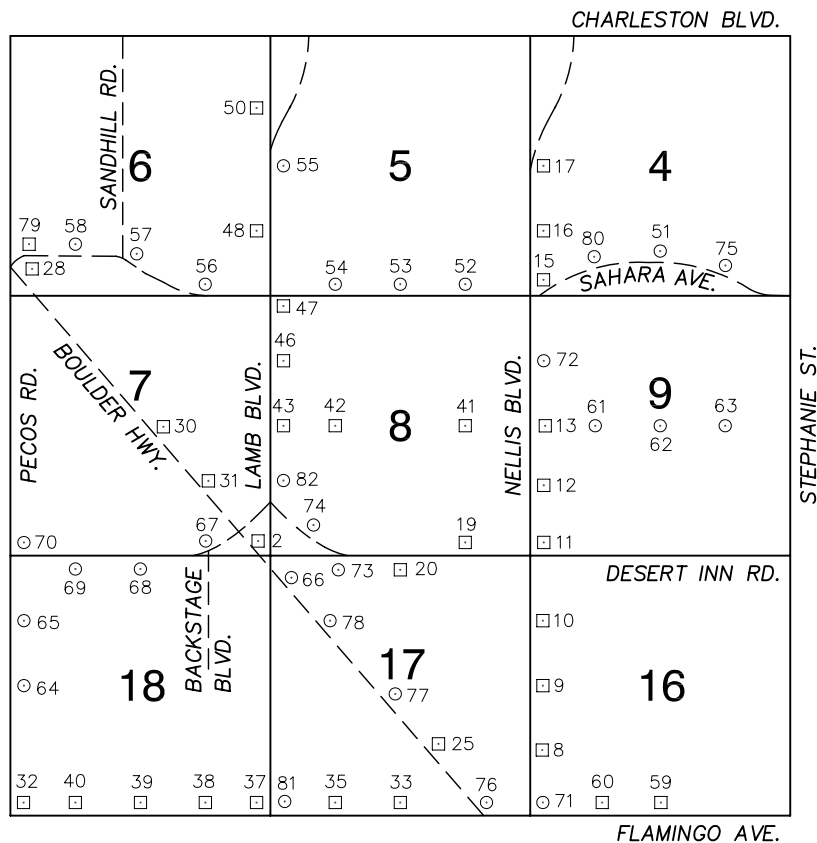

NORTH AMERICAN VERTICAL
DATUM OF 1988
- ALL ELEVATIONS IN METERS -

No.	STATION	ELEVATION (METERS)	DESCRIPTION
1			LOST 2003
2	6C12 7SES	550.131	F N D RIVET AND SQUARE ALUMINUM PLATE IN LIGHT POLE BASE SOUTHEAST CORNER OF BOULDER HWY. AND LAMB BLVD.
3			LOST 2003
4			LOST 2003
5			LOST 2003
6			LOST 2003
7			LOST 2003
8	6C12 16SWW6	519.835	F N D RIVET AND SQUARE ALUMINUM PLATE IN TOP OF CURB, NORTHEAST CORNER OF NELLIS BLVD. AND THE ENTRANCE TO 3890 NELLIS BLVD. (HOLIDAY TRAVEL PARK) NEAR THE PC OF NELLIS BLVD.
9	6C12 16W4	521.002	F N D RIVET AND SQUARE ALUMINUM PLATE IN TOP OF CURB, NORTHEAST CORNER OF NELLIS BLVD. AND TWAIN AVE. NEAR THE PC OF NELLIS BLVD.
10	6C12 16NWW6	522.497	F N D RIVET AND SQUARE ALUMINUM PLATE IN TOP OF CURB, EAST SIDE OF NELLIS BLVD. AT VISTA FLORA WAY ALIGNMENT.
11	6C12 9SWS	524.149	F N D RIVET AND SQUARE ALUMINUM PLATE IN TOP OF CURB, NORTHEAST CORNER OF NELLIS BLVD. AND DESERT INN RD. JUST NORTH OF A LIGHT POLE.
CLARK COUNTY VERTICAL CONTROL v.2003			
CLARK COUNTY SURVEYOR'S OFFICE 5051 SOUTH PARADISE ROAD LAS VEGAS, NEVADA 89119 (702) 455-0640			CONVERSION FACTOR: METERS X $\left(\frac{3937}{1200}\right)$ = U.S. SURVEY FEET
REVISED 02/14/2005		SHEET 1 OF 4	21-62 NW

No.	STATION	ELEVATION (METERS)	DESCRIPTION	No.	STATION	ELEVATION (METERS)	DESCRIPTION
12	6C12 9SWW6	525.205	F N D RIVET AND SQUARE ALUMINUM PLATE IN TOP OF CURB, NORTHEAST CORNER OF NELLIS BLVD. AND HAPPY VALLEY DR.	25	6C12 17SE6	529.197	F N D RIVET AND SQUARE ALUMINUM PLATE IN TOP OF CURB, NORTHEAST CORNER OF BOULDER HWY. AND THE ENTRANCE TO THE ROAD RUNNER TRAVEL PARK NEAR THE PC OF BOULDER HWY.
13	6C12 9W4	525.151	F N D RIVET AND SQUARE ALUMINUM PLATE IN TOP OF CURB, NORTHEAST CORNER OF NELLIS BLVD. AND VEGAS VALLEY DR. NEAR THE PC OF NELLIS BLVD.	26			LOST 2003
14			LOST 2003	27			LOST 2003
15	6C12 4SWS	527.604	F N D RIVET AND SQUARE ALUMINUM PLATE IN TOP OF CURB, NORTHEAST CORNER OF NELLIS BLVD. AND SAHARA AVE. NEAR THE PC OF NELLIS BLVD.	28	6C12 6SWS	555.361	F N D RIVET AND SQUARE ALUMINUM PLATE IN TOP OF CURB, NORTH OF GLEN AVE. AND EAST OF BOULDER HWY. NEAR THE PC OF BOULDER HWY. AT 3465 BOULDER HWY.
16	6C12 4SWW6	528.582	F N D RIVET AND SQUARE ALUMINUM PLATE IN TOP OF CURB, NORTHEAST CORNER OF NELLIS BLVD. AND BOSTON AVE.	29			LOST 2003
17	6C12 4W4	529.046	F N D RIVET AND SQUARE ALUMINUM PLATE IN TOP OF CURB, NORTHEAST CORNER OF NELLIS BLVD. AND WYOMING AVE. NEAR THE PC OF NELLIS BLVD.	30	6C12 7C4	553.861	F N D RIVET AND SQUARE ALUMINUM PLATE IN TOP OF CURB, EAST SIDE OF BOULDER HWY. AT NORTH PROPERTY LINE OF 3745 BOULDER HWY. AT PROJECTED CENTERLINE OF SANDHILL RD.
18			LOST 2003	31	6C12 7SE6	550.950	F N D RIVET AND SQUARE ALUMINUM PLATE IN TOP OF CURB, EAST SIDE OF BOULDER HWY. AT THE PC OF ON-RAMP U.S. 93-95.
19	6C12 8SSE6	525.243	F N D RIVET AND SQUARE ALUMINUM PLATE IN TOP OF CURB, NORTHEAST CORNER OF DESERT INN RD. AND ALOHA ST. /VISTA DEL NORTE NEAR THE PC OF DESERT INN RD.	32	6C12 18SWS	577.678	F N D RIVET AND SQUARE ALUMINUM PLATE IN TOP OF CURB, NORTHEAST CORNER OF PECOS RD. AND FLAMINGO RD. NEAR THE PC OF PECOS RD.
20	6C12 17N4	533.250	F N D RIVET AND SQUARE ALUMINUM PLATE IN TOP OF CURB, SOUTHEAST CORNER OF DESERT INN RD. AND MOUNTAIN VISTA ST. NEAR THE PC OF DESERT INN RD.	33	7C12 17S4	530.282	F N D RIVET AND SQUARE ALUMINUM PLATE IN TOP OF CURB, NORTHEAST CORNER OF FLAMINGO RD. AND MOUNTAIN VISTA ST. NEAR THE PC FLAMINGO RD.
21			LOST 2003	34			LOST 2003
22			LOST 2003	35	7C12 17SSW6	540.492	F N D RIVET AND SQUARE ALUMINUM PLATE IN TOP OF CURB, NORTHEAST CORNER OF FLAMINGO RD. AND SEVILLE ST.
23			LOST 2003	CLARK COUNTY VERTICAL CONTROL v.2003 CLARK COUNTY SURVEYOR'S OFFICE 5051 SOUTH PARADISE ROAD LAS VEGAS, NEVADA 89119 (702) 455-0640			
24			LOST 2003				
				CONVERSION FACTOR: METERS X $\left(\frac{3937}{1200}\right)$ = U.S. SURVEY FEET REVISED 02/14/2005			
				SHEET 2 OF 4 21-62 NW			

No.	STATION	ELEVATION (METERS)	DESCRIPTION		No.	STATION	ELEVATION (METERS)	DESCRIPTION					
36				LOST 2003	49				LOST 2003				
37	7C12 18SES	560.518	F N D	RIVET AND SQUARE ALUMINUM PLATE IN TOP OF CURB, NORTHEAST CORNER OF FLAMINGO RD. AND HAZELCREST ST. AT FREEWAY EXIT, SOUTH AND EAST BOUND, NEAR THE PC OF FLAMINGO RD.	50	7C12 6NEE6	535.122	F N D	RIVET AND SQUARE ALUMINUM PLATE IN TOP OF CURB, NORTHWEST CORNER OF OLIVE ST. AND BROADALBIN DR. NEAR THE PC OF BROADALBIN DR.				
38	7C12 18SSE6	564.035	F N D	RIVET AND SQUARE ALUMINUM PLATE IN TOP OF CURB, NORTHWEST CORNER OF FLAMINGO RD. AND ANNIE OAKLEY DR. — BROADGATE LANE, NEAR THE PC OF FLAMINGO RD.	51	8C12 4S4 1998	524.767	S E T	RIVET AND ROUND ALUMINUM PLATE IN TOP OF CURB, NORTHEAST CORNER OF SAHARA AVE. AND WINTERWOOD BLVD. NEAR THE PC OF SAHARA AVE.				
39	7C12 18S4	572.600	F N D	RIVET AND SQUARE ALUMINUM PLATE IN TOP OF CURB, NORTHWEST CORNER OF FLAMINGO RD. AND SANDHILL RD. NEAR THE PC OF FLAMINGO RD.	52	8C12 5SSE6 1998	529.606	S E T	RIVET AND ROUND ALUMINUM PLATE IN TOP OF CURB, NORTHEAST CORNER OF SAHARA AVE. AND LAMONT ST. NEAR THE PC OF SAHARA AVE.				
40	7C12 18SSW6	576.274	F N D	RIVET AND SQUARE ALUMINUM PLATE IN TOP OF CURB, NORTHEAST CORNER OF FLAMINGO RD. AND PEARL ST. NEAR THE PC OF FLAMINGO RD.	53	8C12 5S4 1998	531.746	S E T	RIVET AND ROUND ALUMINUM PLATE IN TOP OF CURB, NORTHEAST CORNER OF SAHARA AVE. AND ARDEN AVE. NEAR THE PC OF SAHARA AVE.				
41	7C12 8E6	526.780	F N D	RIVET AND SQUARE ALUMINUM PLATE IN TOP OF CURB, NORTH SIDE OF VEGAS VALLEY DR. AT ALOHA ST. ALIGNMENT.	54	8C12 5SSW6 1998	536.408	S E T	RIVET AND ROUND ALUMINUM PLATE IN TOP OF CURB, NORTHEAST CORNER OF SAHARA AVE. AND MARION AVE. NEAR THE PC OF SAHARA AVE.				
42	7C12 8W6	538.456	F N D	RIVET AND SQUARE ALUMINUM PLATE IN TOP OF CURB, NORTHEAST CORNER OF VEGAS VALLEY DR. AND MARION ST. NEAR THE PC OF VEGAS VALLEY DR.	55	8C12 5W4 1998	536.513	S E T	RIVET AND ROUND ALUMINUM PLATE IN TOP OF CURB, NORTHEAST CORNER OF LAMB BLVD. AND WYOMING AVE. NEAR THE PC OF LAMB BLVD.				
43	7C12 8W4	543.703	F N D	RIVET AND SQUARE ALUMINUM PLATE IN TOP OF CURB, NORTHEAST CORNER OF VEGAS VALLEY DR. AND LAMB BLVD. NEAR THE PC OF VEGAS VALLEY DR.	56	8C12 6SSE6 1998	543.106	S E T	RIVET AND ROUND ALUMINUM PLATE IN TOP OF CURB, NORTHEAST CORNER OF SAHARA AVE. AND WALNUT RD. NEAR THE PC OF SAHARA AVE.				
44				LOST 2003	57	8C12 6S4 1998	544.437	S E T	RIVET AND ROUND ALUMINUM PLATE IN TOP OF CURB, NORTHEAST CORNER OF SAHARA AVE. AND SANDHILL RD. NEAR THE PC OF SAHARA AVE.				
45				LOST 2003	58	8C12 6SSW6 1998	551.394	S E T	RIVET AND ROUND ALUMINUM PLATE IN TOP OF CURB, NORTH SIDE OF SAHARA AVE. IN LINE WITH THE WEST PROPERTY LINE OF 3655 EAST SAHARA AVE. (SAHARA GLEN APTS.) NEAR P.P.# (P80414).				
46	7C12 8NWW6	542.369	F N D	RIVET AND SQUARE ALUMINUM PLATE IN TOP OF CURB, NORTHEAST CORNER OF LAMB BLVD. AND KAREN AVE. NEAR THE P.C. OF LAMB BLVD.	59	4C12 16S4	515.251	F N D	RIVET AND SQUARE ALUMINUM PLATE IN TOP OF CURB, NORTHWEST CORNER OF FLAMINGO RD. AND CABANA DR. NEAR THE PC OF CABANA DR.				
47	7C12 8NWS	540.638	F N D	RIVET AND SQUARE ALUMINUM PLATE IN TOP OF CURB, SOUTHEAST CORNER OF LAMB BLVD. AND SAHARA AVE. NEAR THE P.C. OF LAMB BLVD.	CLARK COUNTY VERTICAL CONTROL v.2003 CLARK COUNTY SURVEYOR'S OFFICE 5051 SOUTH PARADISE ROAD LAS VEGAS, NEVADA 89119 (702) 455-0640								
48	7C12 6SEE6	537.892	F N D	RIVET AND SQUARE ALUMINUM PLATE IN TOP OF CURB, WEST SIDE OF LAMB BLVD. NORTH OF PATTERSON AVE. ALIGNMENT.									
					CONVERSION FACTOR: METERS X $\left(\frac{3937}{1200}\right)$ = U.S. SURVEY FEET								
					REVISED 2003			SHEET 3 OF 4		21-62 NW			

No.	STATION	ELEVATION (METERS)	DESCRIPTION		No.	STATION	ELEVATION (METERS)	DESCRIPTION			
60	4C12 16SSW6	516.339	F N D	RIVET AND SQUARE ALUMINUM PLATE IN TOP OF CURB, NORTH SIDE OF FLAMINGO RD. 50' WEST OF VAN ST.	73	8C12 17NNW6 1998	542.047	S E T	RIVET AND ROUND ALUMINUM PLATE IN TOP OF CURB, SOUTH SIDE OF DESERT INN RD. NEAR THE ALIGNMENT OF FERNDALE ST.		
61	8C12 9W6 1998	523.235	S E T	RIVET AND ROUND ALUMINUM PLATE IN TOP OF CURB, NORTHEAST CORNER OF VEGAS VALLEY DR. AND JUNIPER HILLS DR. NEAR THE PC OF VEGAS VALLEY DR.	74	8C12 8SWS 1998	548.409	S E T	RIVET AND ROUND ALUMINUM PLATE IN TOP OF CURB, EAST SIDE OF DESERT INN RD. NEAR THE ALIGNMENT OF MAYORGA ST. NEAR 4278 DESERT INN RD.		
62	8C12 9C4 1998	522.116	S E T	RIVET AND ROUND ALUMINUM PLATE IN TOP OF CURB, NORTH SIDE OF VEGAS VALLEY DR. NEAR THE ALIGNMENT OF CABANA DR.	75	8C12 4SSE6 1998	527.082	S E T	RIVET AND ROUND ALUMINUM PLATE IN TOP OF CURB, NORTH SIDE OF SAHARA AT THE OVERPASS FOR THE WINTERWOOD GOLF COURSE, ON THE EAST SIDE OF THE BRIDGE.		
63	8C12 9E6 1998	521.060	S E T	RIVET AND ROUND ALUMINUM PLATE IN TOP OF CURB, NORTH SIDE OF VEGAS VALLEY DR. 500' EAST OF GREEN TREE AVE.	76	7C12 17SES 1997	522.227	S E T	RIVET AND ROUND ALUMINUM PLATE IN TOP OF CURB, NORTHEAST CORNER OF FLAMINGO RD. AND BOULDER HWY. NEAR THE PC OF BOULDER HWY.		
64	8C12 18W4 1998	572.576	S E T	RIVET AND ROUND ALUMINUM PLATE IN TOP OF CURB, NORTHEAST CORNER OF PECOS RD. AND TWAIN AVE. NEAR THE PC OF PECOS RD.	77	7C12 17C4 1997	534.401	S E T	RIVET AND ROUND ALUMINUM PLATE IN TOP OF CURB, NORTHEAST CORNER OF BOULDER HWY. AND INDIOS AVE. NEAR THE PC OF BOULDER HWY.		
65	8C12 18NWW6 1998	567.628	S E T	RIVET AND ROUND ALUMINUM PLATE IN TOP OF CURB, NORTHEAST CORNER OF PECOS RD. AND HAVERFORD AVE. NEAR THE PC OF PECOS RD.	78	7C12 17NW6 1997	541.977	S E T	RIVET AND ROUND ALUMINUM PLATE IN TOP OF CURB, EAST SIDE OF BOULDER HWY. NORTH SIDE OF THE MAIN ENTRANCE TO SUNRISE RV PARK (4445 BOULDER HWY.)		
66	7C12 17NWS 1997	545.832	S E T	RIVET AND ROUND ALUMINUM PLATE IN TOP OF CURB, SOUTHEAST SIDE OF BOULDER HWY. AND THE ENTRANCE TO THE KOA CAMPGROUND, (4315 BOULDER HWY.)	79	7C12 6SWS	553.913	F N D	RIVET AND SQUARE ALUMINUM PLATE IN TOP OF CURB, NORTHEAST CORNER OF SAHARA AVE. AND PALM RD. NEAR THE PC OF SAHARA AVE.		
67	8C12 7SSE6 1998	552.086	S E T	RIVET AND ROUND ALUMINUM PLATE IN TOP OF CURB, NORTH SIDE OF DESERT INN RD. NEAR THE ALIGNMENT OF BACKSTAGE BLVD. NEAR P.P.#(60994).	80	8C12 4SSW6 1998	525.200	S E T	RIVET AND ROUND ALUMINUM PLATE IN TOP OF CURB, NORTH SIDE OF SAHARA AVE. AT TEE ST. ALIGNMENT.		
68	8C12 18N4 1998	557.000	S E T	RIVET AND ROUND ALUMINUM PLATE IN TOP OF CURB, SOUTHEAST CORNER OF DESERT INN RD. AND SANDHILL RD. NEAR THE PC OF DESERT INN RD.	81	8C12 17SWS 1998	550.688	S E T	RIVET AND ROUND ALUMINUM PLATE IN TOP OF CURB, NORTH SIDE OF FLAMINGO RD. ON AN ISLAND, NEAR THE ENTRANCE TO NORTH BOUND 515-95		
69	8C12 18NNW6 1998	562.339	S E T	RIVET AND ROUND ALUMINUM PLATE IN TOP OF CURB, SOUTHEAST CORNER OF DESERT INN RD. AND WAYNE ST. NEAR THE PC OF DESERT INN RD.	82	8C12 8SWW6 1998	546.864	S E T	RIVET AND ROUND ALUMINUM PLATE IN TOP OF CURB, NORTHEAST CORNER OF LAMB BLVD. AND RIDGEDALE AVE. NEAR THE PC OF RIDGEDALE AVE.		
70	8C12 7SWS 1998	568.428	S E T	RIVET AND ROUND ALUMINUM PLATE IN TOP OF CURB, NORTHEAST CORNER OF DESERT INN RD. AND PECOS RD. NEAR THE PC OF DESERT INN RD.	83						
71	7C12 16SWS 1997	519.455	S E T	RIVET AND ROUND ALUMINUM PLATE IN TOP OF CURB, NORTHEAST CORNER OF NELLIS BLVD. AND FLAMINGO RD. NEAR THE PC OF NELLIS BLVD.	CLARK COUNTY VERTICAL CONTROL v.2003 CLARK COUNTY SURVEYOR'S OFFICE 5051 SOUTH PARADISE ROAD LAS VEGAS, NEVADA 89119 (702) 455-0640						
72	7C12 9NWW6 1997	527.186	S E T	RIVET AND ROUND ALUMINUM PLATE IN TOP OF CURB, NORTHEAST CORNER OF NELLIS BLVD. AND SPYGLASS HILL DR. NEAR THE PC OF NELLIS BLVD.							
					CONVERSION FACTOR: METERS X $\left(\frac{3937}{1200}\right)$ = U.S. SURVEY FEET						
					REVISED 2003			SHEET 4 OF 4		21-62 NW	